

NOTICE OF APPLICATION FOR AN EXPLORATION LICENCE

Mineral Resources (Sustainable Development) Act 1990 – Section 15(5)

Mineral Resources (Sustainable Development) (Mineral Industries) Regulations 2019 – Regulation 22(1) and Schedule 1

1. Name and address of applicant(s):

Mitre Hill Pty Ltd
C/-PO Box 440, Hove SA 5048

2. Contact details of applicant (for map and other information requests):

Melissa Say, Authorised Agent (as employee of Australian Mining & Exploration Title Services)
Mobile: 0429 787 593 Email: vic@amets.com.au

3. Applicant's Website (see notes) Further information about this application is available at the following websites: www.amets.com.au/victoria-tenements/ and www.earthresources.vic.gov.au/licenceapplications

4. Details of the application:

Application number: EL007641

Locality of the land to which the application relates: 32km northwest of Casterton, 13km southwest of Dergholm

Approximate area of the application (Graticular Sections): 103

Date of the application: 17 June 2021

Term the licences are applied for: 5 years

Outline of the proposed programs of work: Desktop studies, geophysics, mapping, geochemical sampling, drilling.

5. Objections and Comments:

Any person may object or comment to a licence being granted by:

- a. putting the objection or comment in writing; and
- b. including the grounds on which it is made

Objections or comments must be lodged within 21 days after the latest date on which the application was advertised and can be lodged online or posted to:

The Minister for Resources

c/- Manager Licensing, Earth Resources Regulation, GPO Box 4509, Melbourne Victoria 3001

It is recommended that objections or comments are lodged online to ensure timely consideration:
<https://rram.force.com/ObjectionSubmission>

Enquiries can be made by writing to the Manager Licensing at the above address or by phoning the Earth Resources Information Centre on 1300 366 356.

6. Other information:

- a. Subject to other requirements being satisfied, an exploration licence, if granted, entitles the holder of the licence to explore and search for minerals in the relevant land, but does not entitle the holder to undertake mining.
- b. Further information regarding the requirements that must be complied with prior to work being undertaken is available on the department's Community & Land Use page: <https://earthresources.vic.gov.au/community-and-land-use>

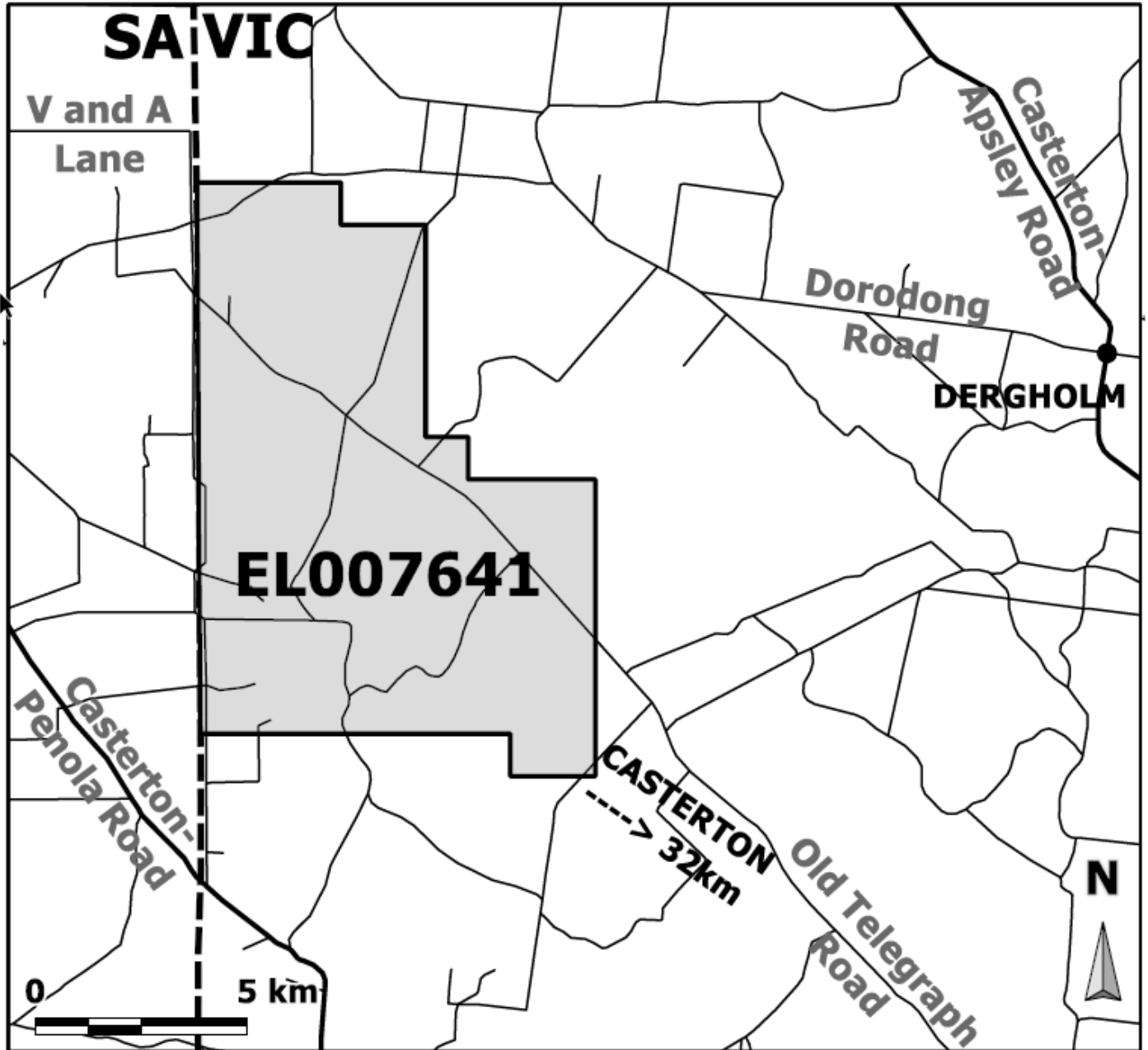

EXPLORATION LICENCE APPLICATION 007641

- Unavailable for Searching or Exploration or Mining MRSDA 1990 Sec 6. Includes National, State & Wilderness Parks and Reference Areas
- Exempted from being subject to Exploration &/or Mining Licences. MRSDA 1990 Sec 7. May be revoked by notice in the Govt Gazette.
- Restricted Crown Land. Schedule 3 of MRSDA 1990. Consent required to do work on the land.
- Other Crown Land
- Commonwealth Land. Subject to Commonwealth legislation.
- Exploration Initiative Area exempted for a limited time from being subject to Exploration and/or Mining Licences. MRSDA 1990 Sec. 7
- Land not included in the Licence due to a licence or licence application existing or having priority at the date of application.

Native Title Appropriate Claims or Determination Area (grey)

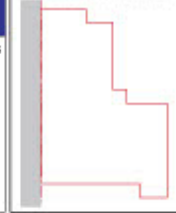

Water Supply Catchment Area (grey)

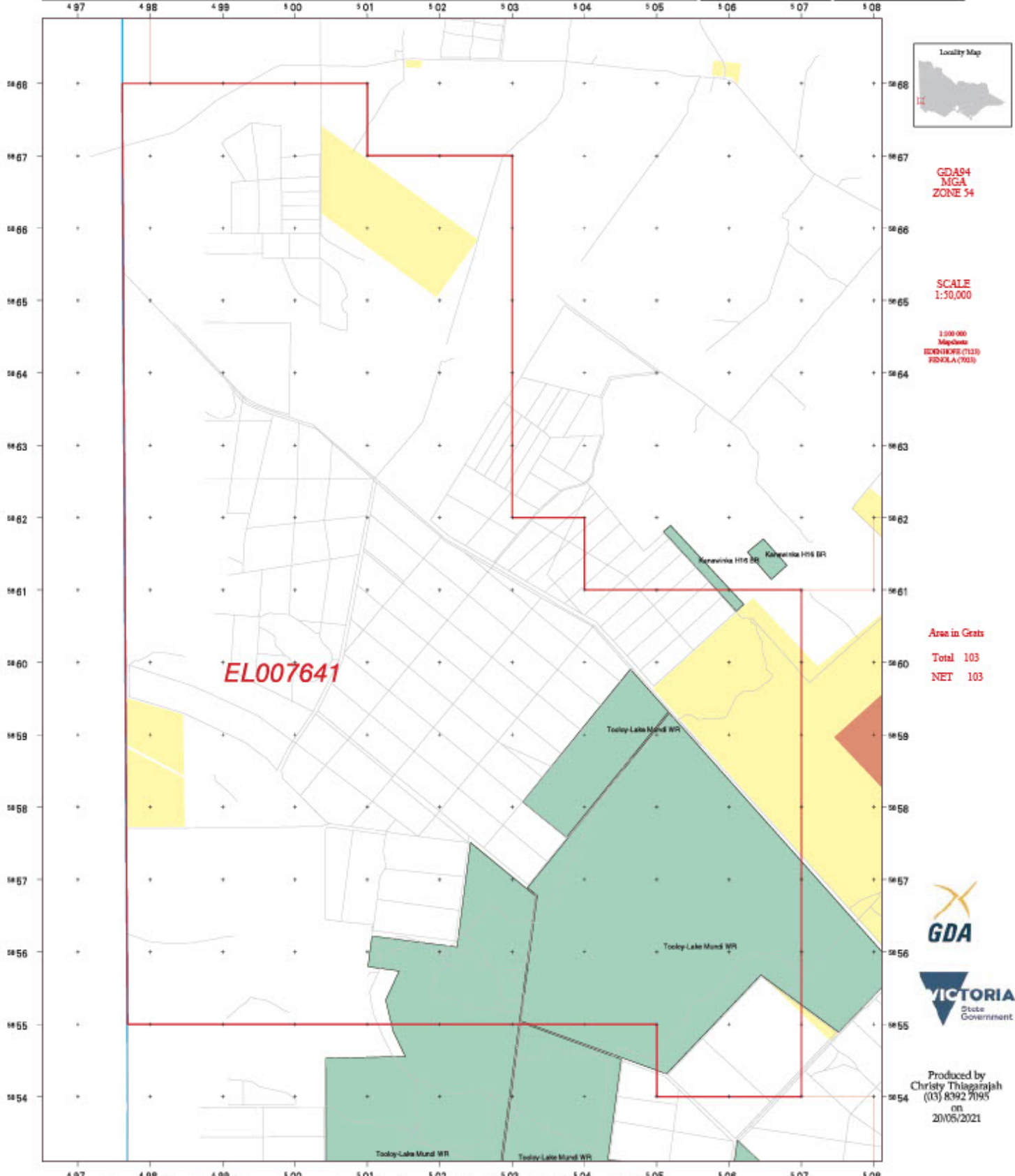
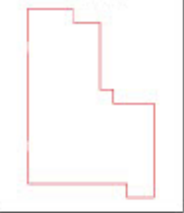

EL007641



GDA94
MGA
ZONE 54

SCALE
1:50,000

1:500,000
MapScale
ECONOMICS (113)
FDKLA (703)

Area in Grats
Total 103
NET 103



Produced by
Christy Thiagarajah
(03) 8392 7095
on
20/05/2021

NOTE: The accuracy of the location of the land status areas may vary according to the scale and mapping accuracy. Areas of private land within Crown Land may not be shown. The precise locations should be verified with Crown Land & Assets if access to the land is proposed.

Where the Licence Application abuts unavailable land, the Licence boundary is defined by the boundary of the Unavailable Land. Discrepancies on this plan between the boundaries may be due to scale and mapping inaccuracy.

Work Program

Years 1 - 2

- Collection of historical exploration and mining undertaken through the project
- Review of historical information sources such as newspapers, reports, previous research
- Initial desktop review of communities and environment
- Review of available government data relating to geophysical and geochemical assessments
- Field reconnaissance investigations/mapping to develop understanding of geology
- Surface geochemical sampling

Years 2 - 3

- More intensive surface geological mapping obtaining lithological and structural information
- Surface geochemical exploration (collection of rock chip, soil, stream, vegetation, water samples for chemical analysis)
- Geophysical methods involving assessing subsurface geology
- Shallow drilling or augering to obtain subsurface geological samples

Years 3 - 5

- Design a larger drill program, with associated assays, seeking to rapidly identify the potential to define a resource over the project.
- Initial mineralogical test work on the project.

Environment Strategy and Community Engagement Plan

Mitre Hill Pty Ltd is committed to minimising, or where possible avoiding environmental impact and will work in accordance with the Guidelines as determined by the Victorian Government, facilitating effective rehabilitation of all disturbed areas as soon as is practicable after exploration activities have taken place. Mitre Hill Pty Ltd will ensure all staff and contractors are made aware of all site-specific environmental sensitivities, such as weeds and endangered flora and fauna and will act accordingly. No wetlands, waterways or lakes will be impacted by exploration activities.

Mitre Hill Pty Ltd is committed to identifying and communicating with its stakeholders, particularly local landowners and occupiers, persons living on or in the vicinity of the licence and other community groups who may be directly or indirectly affected by exploration activities.

Consultation with the relevant land managers/owners early in the planning process will ensure that all relevant community stakeholders are identified. A register of community contacts will be recorded throughout the life of the exploration licence.

Consent will be sought from the landowners before any activities are undertaken on their land. Mitre Hill Pty Ltd will listen to and address the concerns of the community regarding exploration activities and will work with landowners when planning activities to ensure landowners are not disadvantaged or inconvenienced. Following the consultation, the full impact would be assessed by guidelines provided by the Department.

Mitre Hill Pty Ltd is mindful of the need to maintain these exceptionally good community relations and to ensure that the channels of communication between the licence holder and the community in which it operates are kept open. All discussion with the community is based on mutual trust and respect.

The community is welcomed for their interest and input into ensuring that there are minimum adverse effects to the amenity of the area, or the impact on the expectation of the community for the peaceful enjoyment of their local environment.