

## **NOTICE OF APPLICATION FOR AN EXPLORATION LICENCE**

*Mineral Resources (Sustainable Development) Act 1990 – Section 15(5)*

*Mineral Resources (Sustainable Development) (Mineral Industries) Regulations 2019 – Regulation 22(1) and Schedule 1*

### **1. Name and address of applicant(s):**

CGM (WA) Pty Ltd

C/-PO Box 563, East Maitland NSW 2323

### **2. Contact details of applicant (for map and other information requests):**

Belinda Ingram, Authorised Agent (as employee of Australian Mining & Exploration Title Services)

Mobile: 0428 158 374. Email: vic@amets.com.au

**3. Applicant's Website (see notes)** Further information about this application is available at the following websites: [www.amets.com.au/victoria-tenements/](http://www.amets.com.au/victoria-tenements/) and [www.earthresources.vic.gov.au/licenceapplications](http://www.earthresources.vic.gov.au/licenceapplications)

### **4. Details of the application:**

**Application number:** EL007656

**Locality of the land to which the application relates:** 5km east of Maryborough, 100m west of Moolort, 400m south of Carisbrook, including Majorca

**Approximate area of the application (Graticular Sections):** 198

**Date of the application:** 9 June 2022

**Term the licences are applied for:** 5 years

**Outline of the proposed programs of work:** Desktop studies, geological modelling, drilling

### **5. Objections and Comments:**

Any person may object or comment to a licence being granted by:

- a. putting the objection or comment in writing; and
- b. including the grounds on which it is made

Objections or comments must be lodged within 21 days after the latest date on which the application was advertised and can be lodged online or posted to:

The Minister for Resources

c/- Manager Licensing, Earth Resources Regulation, GPO Box 4509, Melbourne Victoria 3001

It is recommended that objections or comments are lodged online to ensure timely consideration:

<https://rram.force.com/ObjectionSubmission>

Enquiries can be made by writing to the Manager Licensing at the above address or by phoning the Earth Resources Information Centre on 1300 366 356.

### **6. Other information:**

- a. Subject to other requirements being satisfied, an exploration licence, if granted, entitles the holder of the licence to explore and search for minerals in the relevant land, but does not entitle the holder to undertake mining.
- b. Further information regarding the requirements that must be complied with prior to work being undertaken is available on the department's Community & Land Use page: <https://earthresources.vic.gov.au/community-and-land-use>

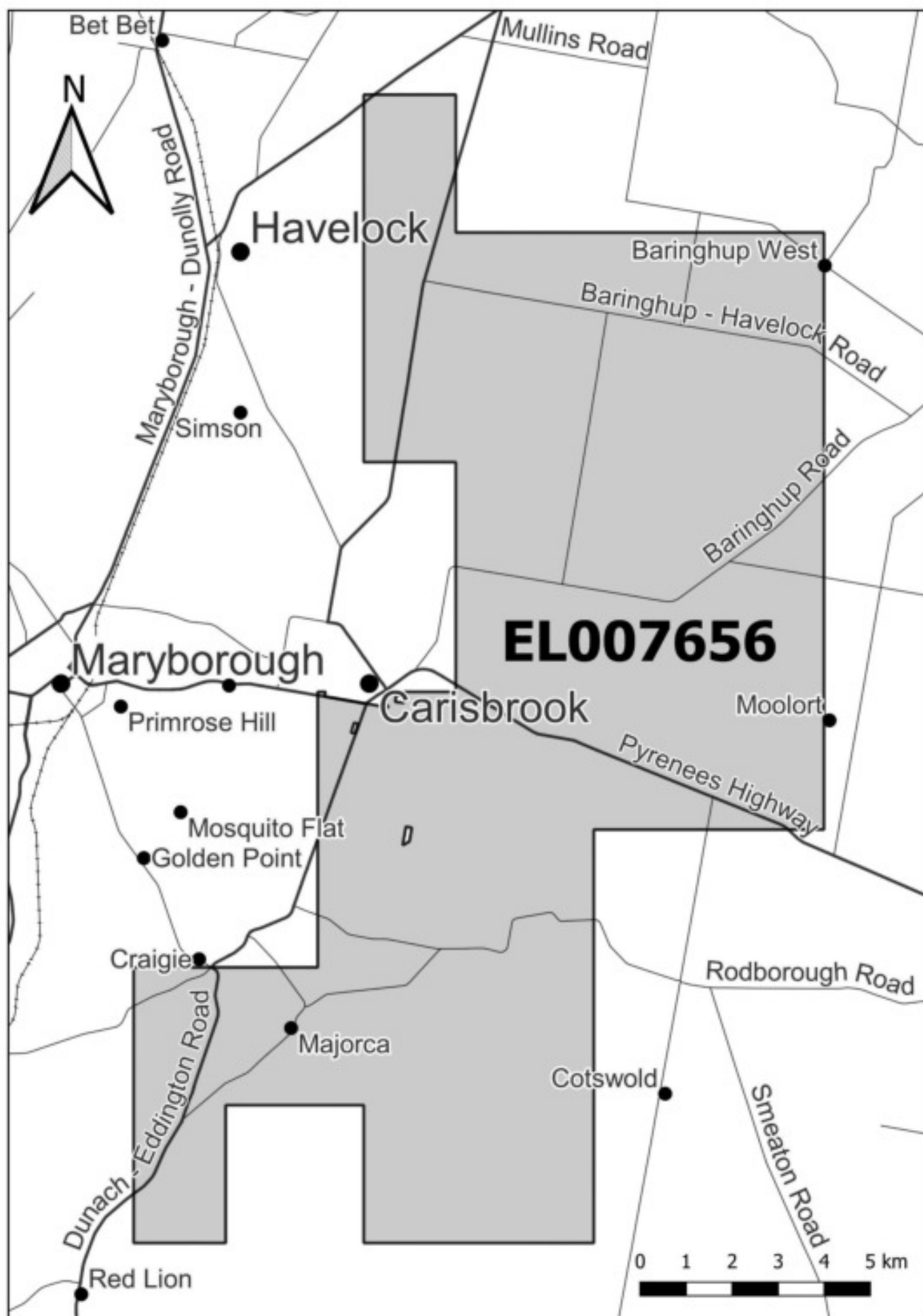

# EXPLORATION LICENCE APPLICATION 007656

- Unavailable for Searching or Exploration or Mining MRSDA 1990 Sec 6. Includes National, State & Wilderness Parks and Reference Areas
- Exempted from being subject to Exploration &/or Mining Licences, MRSDA 1990 Sec 7. May be revoked by notice in the Govt Gazette.
- Restricted Crown Land, Schedule 3 of MRSDA 1990. Consent required to do work on the land.
- Other Crown Land
- Commonwealth Land. Subject to Commonwealth legislation.
- Exploration Initiative Area exempted for a limited time from being subject to Exploration and/or Mining Licences, MRSDA 1990 Sec. 7
- Land not included in the Licence due to a licence or licence application existing or having priority at the date of application.

Native Title Approximate Claim or Determination Area (grey)

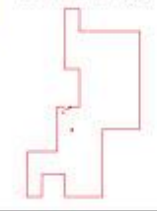

Major Supply Catchment Area (grey)

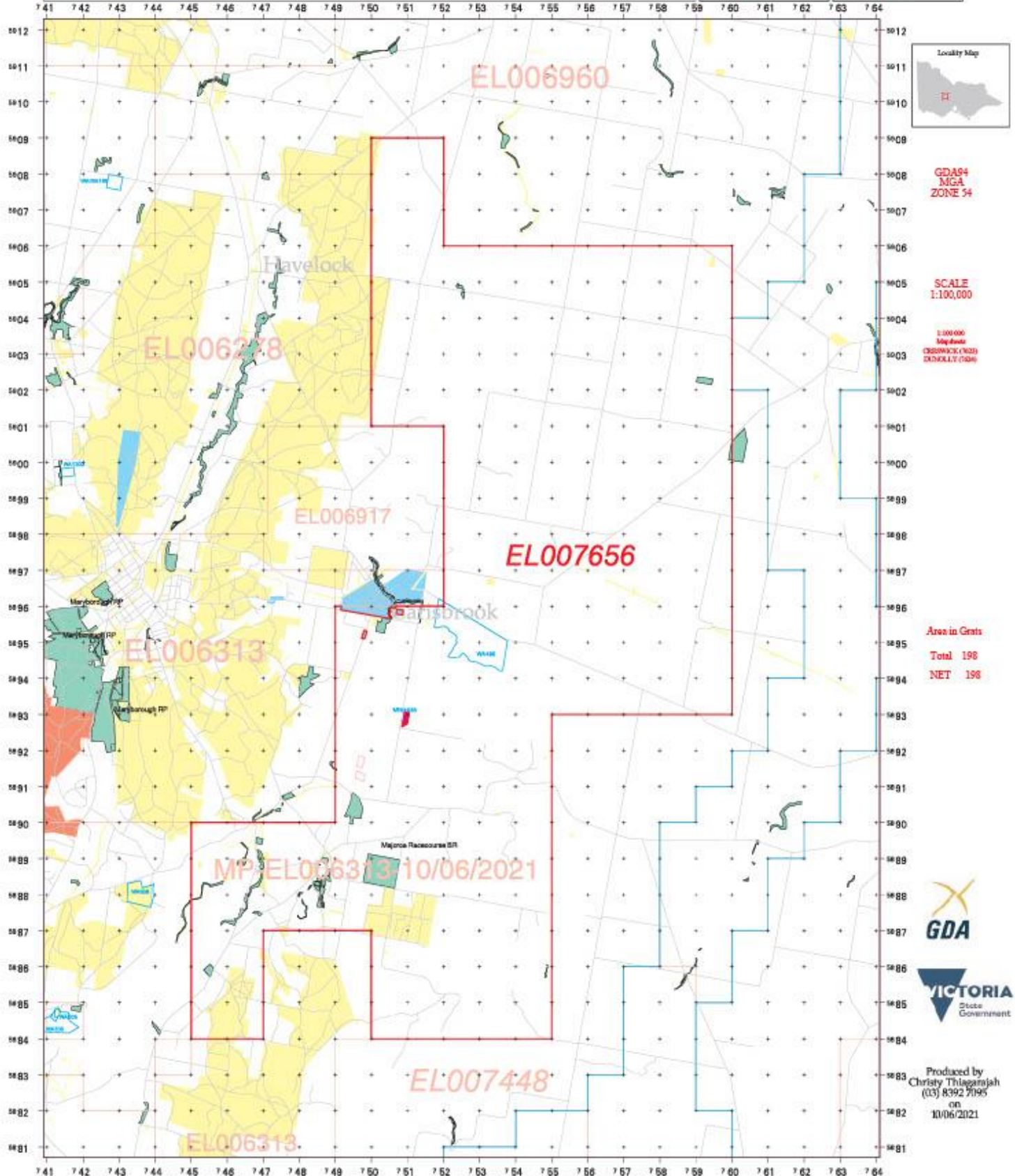

GDA94  
MGA  
ZONE 54

SCALE  
1:100,000

1:100,000  
Topographic  
Contours (1:25,000)  
Datum: MGA94 (2011)

Area in Gnts  
Total 198  
NET 198



Produced by  
Christy Thilagaramah  
(03) 8392 7095  
on  
10/06/2021

NOTE: The accuracy of the location of the land status areas may vary according to the scale and mapping accuracy. Areas of private land within Crown Land may not be shown. The precise locations should be verified with Crown Land & Assets if some to the land is proposed.

Where the Licence Application shows unavailable land, the Licence boundary is defined by the boundary of the Unavailable Land. Discrepancies on this plan between the boundaries may be due to scale and mapping inaccuracy.

## **Work Program**

### **Year 1**

- Office-based activities
- Field reconnaissance
- Low Impact AC drilling

### **Year 2**

- Drilling
- Geological modelling.

### **Year 3-5**

- RC and/or Diamond drilling
- Geological modelling

## **Fit and Proper Licence Holder**

Chalice Gold Mines (CGM) hold clear values in relation to Community Engagement, the Environment and Health and Safety across all project areas, working closely with key stakeholders, ensuring that high standards of corporate responsibility are maintained throughout its operations. In relation to Victoria in particular, the applicant believes it has built a reputation of upholding those high corporate, social and environmental standards, recognising the importance of building respectful and inclusive relationships with local stakeholders, communities, and governing organisations. The means to achieve this is briefly outlined below.

## **Community Engagement**

- A commitment to open and transparent communication with the communities in which it operates, welcoming any feedback from local members from planning stage to on-ground exploration.
- Making up to date information available through various means, including door knocking, information handouts, advertising and website posting.
- Providing mechanisms for stakeholder feedback.
- A commitment to supporting local communities in the vicinity of its projects through the provision of local employment opportunities, use of local businesses and community partnering initiatives consistent with the applicant's values.

## **Environment**

Chalice Gold Mines (CGM) is committed to the responsible environmental management of all of its activities to ensure that the environmental effects are either prevented, or unavoidable impacts are minimised, and where possible, remediated to an acceptable standard.

To achieve the standards of environmental performance the applicant seeks to:

- Satisfy all legal obligations imposed on the Company's activities through leases, licences, approvals, consents, or notices.
- Integrate environmental factors into planning of programs.
- Care for the environment and value culture heritage by having respect for the traditional rights of indigenous peoples.
- Promote environmental awareness among Company personnel and contractors to increase understanding of environmental matters.